



STUDENT SUSTAINABILITY COMMITTEE

Semesterly Report

Thank you for your commitment to green initiatives at the University of Illinois. One of the ongoing requirements listed in the terms of the funding agreement for your project is the submission of semesterly reports with key information about your project. In addition to this form, please provide additional financial documentation and/or progress photos if available.

Please be as accurate as possible in describing the project (including possible setbacks or challenges in meeting the initial goals of the project). Not fully meeting your project's goals will not disqualify you from making future funding requests as long as your reports are as complete and accurate as possible. If you have any questions, please contact the Student Sustainability Committee, at sustainability-committee@illinois.edu.

Project Name: CornCrete

Date of Report Submission: 1/17/2019

Project Purpose:

The Project will divert an agricultural waste product and direct it into a higher value end product: An insulating monolithic wall material.

Detailed Accounting of Expenditures to Date:

To Date the Project has incurred the following expenses:

Menards: \$13.67

Masks Duct Tape etc: \$70.82

Bale of Corn Stover: \$45

Undergrad Labor: \$144

Grad Labor: \$1,707.50

Work Comp:\$12.91

Total to Date: \$1993.90

Balance to Date \$4,5006.1

Project Progress to Date:

The majority of the work to date can be broken down into the following categories:

Design Work: Approx. 45.30 hrs

Material Preparation: Approx. 37 hrs

Student Involvement and Outreach to Date:

All the work carried out to date which has incurred an expense has been the work of one undergraduate and one graduate student. This semester a team of 3-4 graduate students will keep the project moving forward in the setting of a seminar class.

Marketing and Promotion Efforts to Date:

As little has been done other than material acquisition and preparation and design work the team has not made a big effort in relation to marketing and promotion. That said the faculty lead has been interviewed about the work and an article will soon be released via the iSEE website.

Additional Comments:

The most significant development to date is that two buildings have been identified in which the material the team is work with will be installed, one is a single-story building of approximately 400 sq/ft the other has a double height space and a footprint off approximately 1,600 sq/ft that will be enclosed using the material in development. See images below



Building 931
(first building to have CornCrete installed)

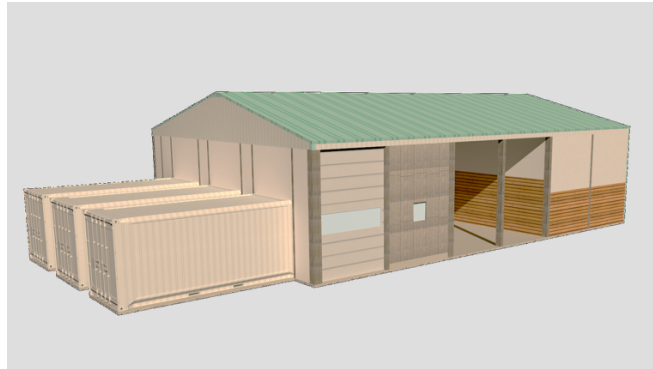

South side of barn will receive Corn Crete (summer 2019)