

► **Code Number**
24521002T

► **Description**
Vitreous china wall hung closet and WES® 111 flushometer combination package. Carbon Neutral Product.

► **Flush Cycle**
1.6 / 1.1 gpf - 6.0 Lpf / 4.2 Lpf

- **Flushometer Specification**
- Quiet, Exposed, Diaphragm Type, Chrome Plated Closet Flushometer for either left or right hand supply with the following features:
 - Includes purchase of forestry carbon credits from the Arbor Day Foundation to offset embedded carbon.
 - Lifting Handle UP initiates reduced flush (1.1 gpf/4.2 Lpf), eliminating liquid and paper waste, saving a 1/2-gallon of water
 - Pushing Handle DOWN initiates full flush (1.6 gpf/6.0 Lpf), eliminating all waste
 - PERMEX® Synthetic Rubber Diaphragm with Dual Filtered Fixed Bypass
 - 1" I.P.S screwdriver Bak-Chek® angle stop
 - High Back Pressure Vacuum Breaker Flush Connection with One-Piece Bottom Hex Coupling Nut, Spud Coupling and Flange for 1-1/2" Top Spud
 - Sweat Solder Adapter w/Cover Tube and Cast Wall Flange with Set Screw
 - Diaphragm, Stop Seat and Vacuum Breaker to be molded from PERMEX® rubber compound for Chloramine resistance
 - Valve Body, Cover, Tailpiece and Control Stop shall be in conformance with ASTM Alloy Classification for Semi-Red Brass. Valve shall be in compliance to the applicable sections of ASSE 1037/ ASME A112.19.2/CSA B45.1

- **Fixture Specification**
- White Vitreous china
 - Elongated bowl
 - Wall mounted, wall outlet
 - Siphon jet flushing action achieves 1000g Map score
 - Water spot area: 10 7/8 x 9 3/8 (26 cm x 24 cm)
 - 1-1/2" I.P.S. top spud inlet
 - 2 1/8" fully glazed trapway
 - Closet bolts and caps included
 - Toilet seat not included

► **Recommended Seats**
Bemis - 1955CT/1955SSCT & 2155CT/2155SSCT
Church - 295CT/295SSCT & 2155CT/2155SSCT

► **Plumbing System Requirements**
Maximum Static Pressure: 80 PSI
Minimum Flow Rate: 25 GPM

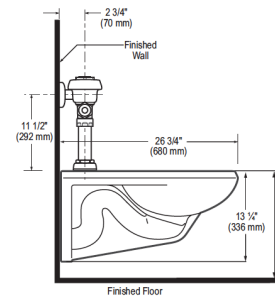
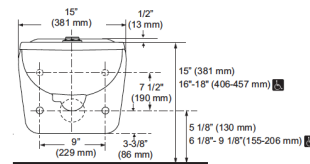
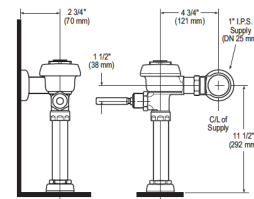

► **Notes**
The precise amount of embedded carbon for this product was calculated and third party verified through Sloan's Environmental Product Declaration which conforms to ISO 14025, 14040, 14044 and 21930.

► **Compliance & Certifications**
CEC Compliant



This space for Architect/Engineer Approval



**Wall Hung Closet Combo Package
with Carbon Offset
Model WETS-2452.1002-CO**

Minimum Flowing Pressure: 25 PSI